



WaterMark
AS4032.1
AS4032.2
Lic.No. 23128



Australian Valve Group

INFORMATION AND INSTRUCTION BOOKLET



**AVG 20mm & 25mm THERMOSTATIC VALVES
FOR USE IN AUSTRALIA & NEW ZEALAND**

The Hi-Flo thermostatic valve range has been designed incorporating low opening energy check valves and is suitable for high or low pressure applications.

The Hi-Flo range includes a standard TVA, high performance/solar TVA and TMV.

The range is also available with isolating hot and cold ball valves/strainers included.

The Hi-Flo Thermostatic Valve is available complete with 20mm or 25mm inlet compression fittings.

The inlet service fittings are union type fittings enabling the thermostatic mixing valve to be removed from its installation without disturbing its pipe work.

The dimensions of the valve are shown below.

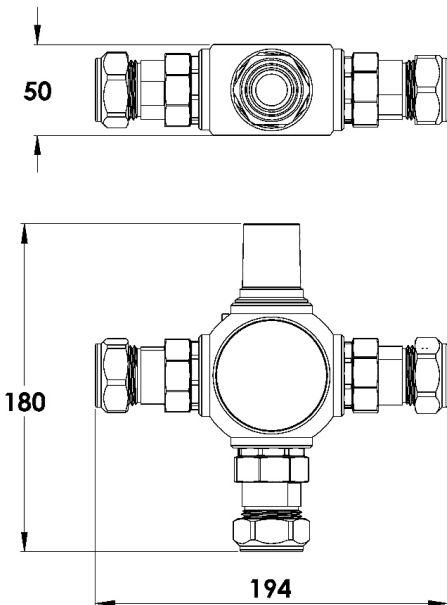

Installation WARNING!

To prevent unnecessary damage to the plastic valve outlet and voiding the product warranty please adhere to the warning label fitted to the outlet of the valve. Using the spanner provided hold the brass outlet fitting while tightening the nut and olive.



“WARNING! DO NOT GRIP THE PLASTIC BODY USE THE BRASS FLATS”

INSTALLATION

Thermostatic valves must be installed by a qualified person in accordance with the manufacturers instructions, AS/NZS 3500 and any local requirements.

IMPORTANT NOTE: Flush lines before connecting the valve.

VALVE ADJUSTMENT

All AVG thermostatic valves are tested and are roughly pre set and may need fine adjustment to suit the application.

TVA's are set to 50C and and TMV's are set to 40C. Unscrew the protective cap off the valve. To increase the mixed outlet temperature, rotate the spindle anti-clockwise. To decrease the mixed outlet temperature, rotate the spindle clockwise. Allow the mixed outlet temperature to stabilize for 60 seconds and once again take a temperature reading. Repeat until the desired temperature has been reached.

Screw the protective cap back onto the top of the valve. Check that the outlet temperature is stable over the full range of flow rates and that the flow rate is adequate for the application. Close the outlet.

The mixing valve is now set and ready for use.

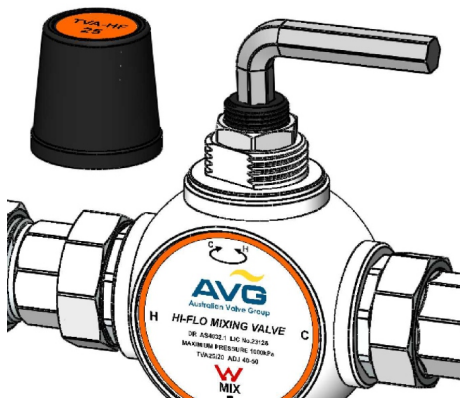

DISINFECTION (THERMAL FLUSH) STEPS

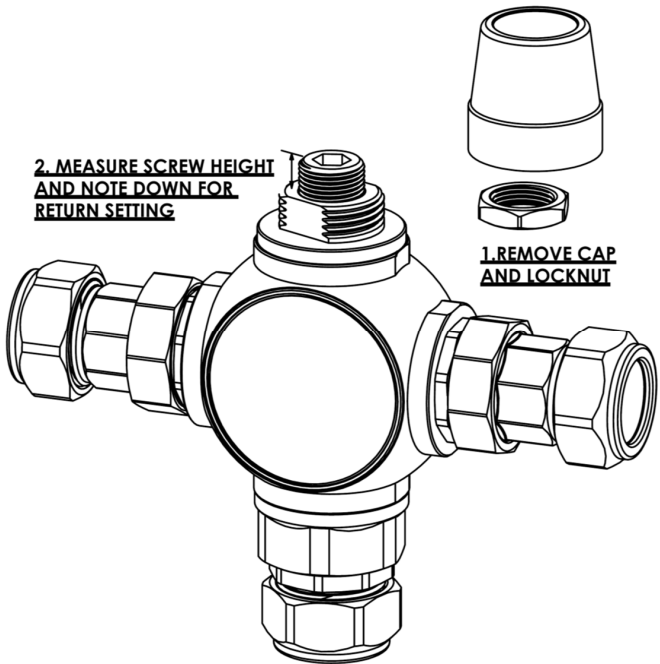

**3. UNSCREW ANTICLOCKWISE
UNTIL STOP IS REACHED USING
10mm ALLEN KEY AND START
DISINFECTION CYCLE**

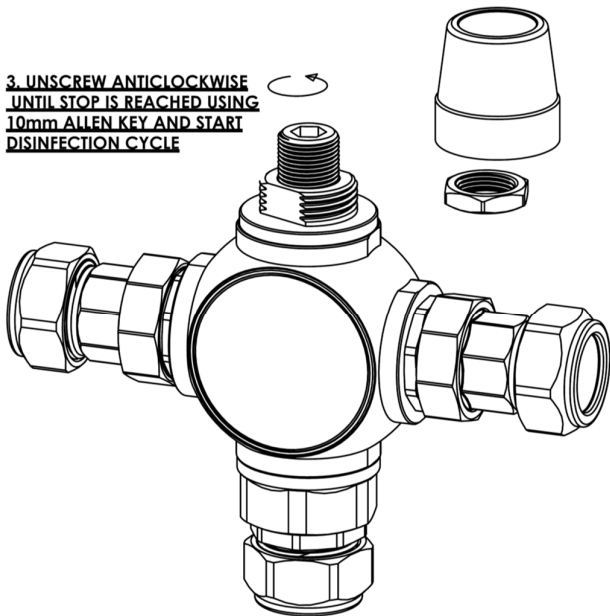

4. AFTER DISINFECTION CYCLE IS COMPLETE, RETURN SCREW TO NOTED HEIGHT AND IF REQUIRED RE-CALIBRATE SET TEMPERATURE.

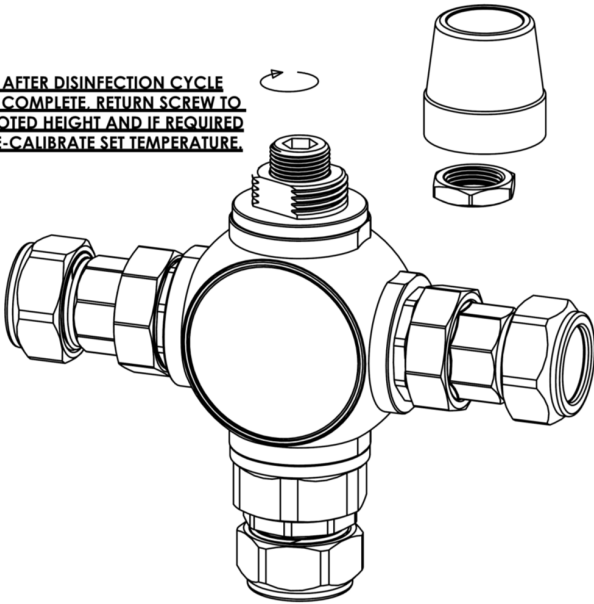

**5. WHEN SATISFIED THAT ALL
SETTING CRITERIA ARE ACHIEVED,
REPLACE LOCKNUT AND CAP.**

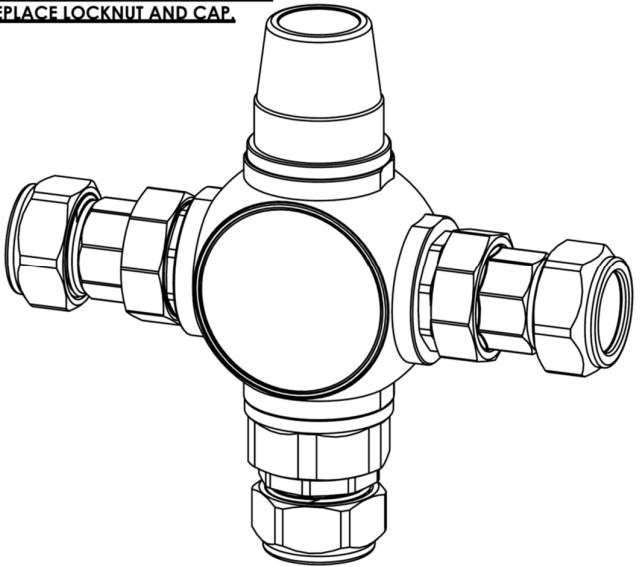

TMVABV-25-SK0 SPECIFICATIONS

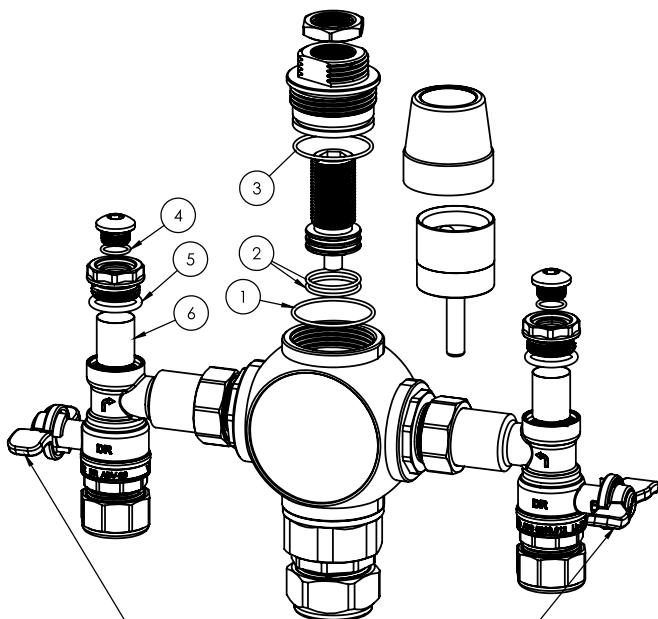

BALL VALVES SHUT BOTH SIDES

TMVABV-25-SK0	
ITEM	DESCRIPTION
1	BODY O-RING
2	2 X ADJUST O-RING
3	TOP O-RING
4	2 X PLUG O-RING
5	2 X CAP O-RING
6	2 X MESH STRAINER

TMV25-SK1 SPECIFICATIONS

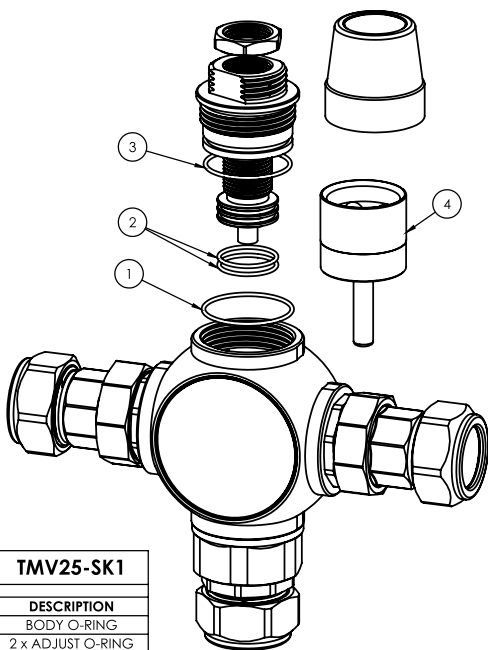

TMV25-SK1	
ITEM	DESCRIPTION
1	BODY O-RING
2	2 x ADJUST O-RING
3	TOP O-RING
4	SHUTTLE/ELEMENT

TMVABV-25-SK1 SPECIFICATIONS

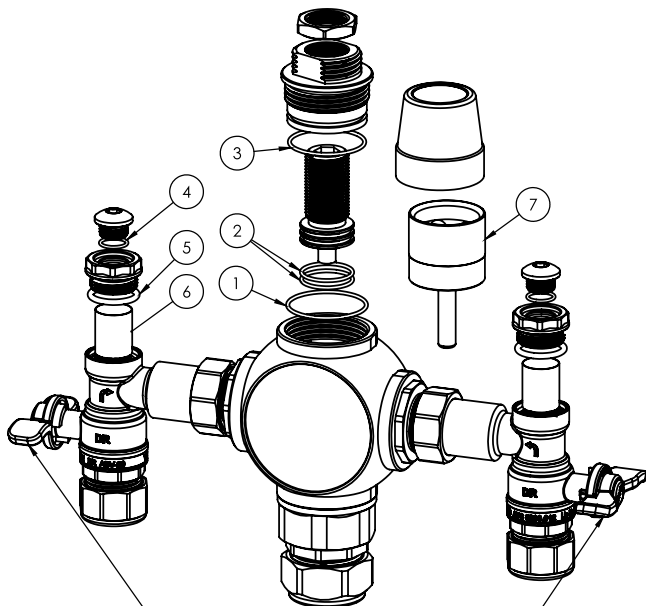

BALL VALVES SHUT BOTH SIDES

TMVABV-25-SK1	
ITEM	DESCRIPTION
1	BODY O-RING
2	2 x ADJUST O-RING
3	TOP O-RING
4	2 x PLUG O-RING
5	2 x CAP O-RING
6	2 x MESH STRAINER
7	SHUTTLE/ELEMENT

TMV25-SK0 SPECIFICATIONS

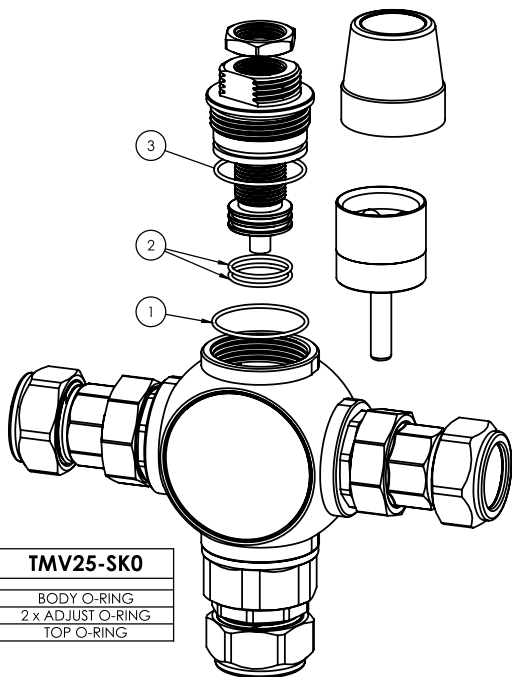

TMV25-SK0	
1	BODY O-RING
2	2 x ADJUST O-RING
3	TOP O-RING

Input Pressure [kPa]

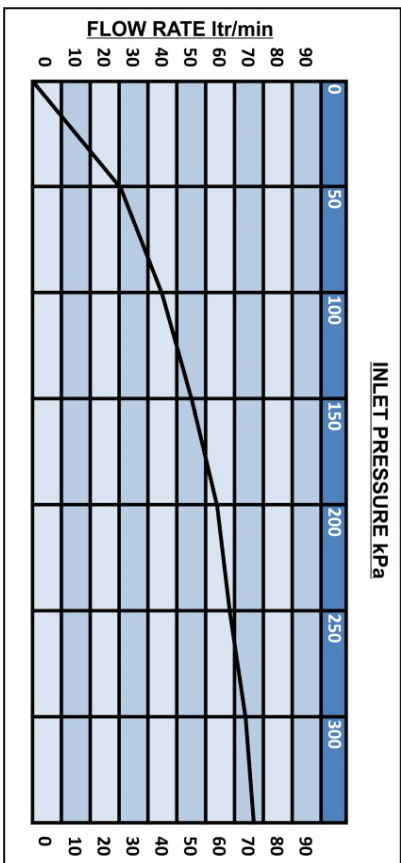

SPECIFICATIONS

Valve body.....	POM
Inlet/outlet connections.....	Chrome plated DR brass
Optional isolation ball valves.....	Chrome plated DR brass
Thermostatic cartridge.....	Polymer
Inlet/Outlet size options.....	1/2" , 3/4" and optional 1"
Check valve assemblies.....	Polymer Body, stainless steel filter, silicone seals
Temperature adjustment range.....	35C - 65C (Disinfection setting) Legionella control
Factory pre-set temperatures.....	40° C or 50 C or 55C
Temperature control.....	+ _ 2C
Hot to Mix Temperature Differential for effective cold water isolation.....	Minimum 15 Celsius
Maximum pressure.....	1000 kPa
Dynamic pressure range.....	20 kPa - 500 kPa
Minimum flow rate.....	4 litres/min

IDEAL FOR LOW PRESSURE APPLICATIONS



AVG WA (Head Office)

Unit 2, 9-11 Noble St, Kewdale, WA, 6105

Tel: (08) 9353 2203 Fax: (08) 9353 2689

1800 AVG AUS (284 287)

www.avg.net.au

